

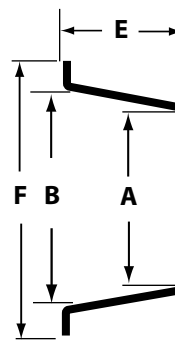

**Tapered Caps & Plugs**

The tapered style can either be used as a cap or plug depending on application. Excellent for protecting threads and keeping unwanted contamination out of pipes, valves, tubing and most other cylindrical openings. The most economical solution for protecting standard size and unified threads.

- Typical wall thickness .032
- Color: Red, Blue - optional
- Material: Low Density Polyethylene
- LDPE service temperature 150° F (66° C)
- Applicable specs: MIL-C-5501/7, MIL-C52078, NAS-834
- Thermoplastic rubber service temperature: 275° F (132° C)
- RoHS compliant



**CAP**

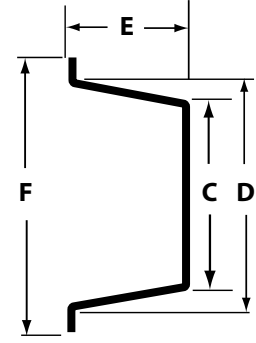

**PLUG**

**TAPERED CAPS**

**TAPERED PLUGS**

CAP PART NUMBER	TYPICAL APPLICATION	A	B	C	D	E	F	TYPICAL APPLICATION	PLUG PART NUMBER
-	-	0.177	0.240	0.237	.0293	0.381	0.473	5/16 Std. Thread	ICP-6
ICP-8	15/64 Std. Thread	0.240	0.301	0.296	0.368	0.385	0.533	3/4 Std. Thread	ICP-8
-	-	0.270	0.331	0.325	0.397	0.377	0.559	1/8 N.P.T.	ICP-9
-	-	0.303	0.362	0.357	0.427	0.380	0.579	7/16 Std. Thread	ICP-10
ICP-11	3/8 Std. Thread	0.327	0.393	0.383	0.460	0.377	0.620	-	-
ICP-12	1/8 N.P.T.	0.362	0.425	0.423	0.488	0.380	0.596	1/4 NPT, 1/2 Std. Thrd.	ICP-12
ICP-13	7/16 Std. Thread	0.386	0.448	0.447	0.512	0.374	0.625	-	-
ICP-14	1/2 Std. Thread	0.410	0.483	0.474	0.554	0.498	0.719	9/16 Std. Thread	ICP-14
ICP-16	1/4 N.P.T.	0.476	0.552	0.529	0.623	0.501	0.752	5/8 Std. Thread	ICP-16
ICP-17	9/16 Std. Thread	0.477	0.569	0.548	0.630	0.500	0.784	3/8 N.P.T.	ICP-17
ICP-18	5/8 Std. Thread	0.525	0.606	0.588	0.676	0.529	0.877	-	-
-	-	0.574	0.658	0.629	0.728	0.492	0.872	3/4 Std. Thread	ICP-20
ICP-21	3/8 N.P.T.	0.616	0.695	0.672	0.755	0.500	0.875	-	-
-	-	0.634	0.722	0.690	0.779	0.620	0.938	1/2 N.P.T.	ICP-22
ICP-23	3/4 Std. Thread	0.659	0.758	0.730	0.827	0.502	1.004	-	-
-	-	0.687	0.783	0.752	0.849	0.621	1.032	7/8 Std. Thread	ICP-24
ICP-25	1/2 N.P.T.	0.736	0.838	0.800	0.914	0.747	1.024	-	-
ICP-26	7/8 Std. Thread	0.750	0.871	0.812	0.933	0.620	1.123	-	-
-	-	0.807	0.910	0.867	0.971	0.747	1.130	3/4 N.P.T.	ICP-27
-	-	0.809	0.907	0.869	0.974	0.629	1.127	3/4 N.P.T.	ICP-27X
-	-	0.829	0.967	0.893	1.038	0.620	1.153	1-1/16 Std. Thread	ICP-28
ICP-30	3/4 N.P.T.	0.838	1.021	0.955	1.092	0.747	1.243	-	-
ICP-31	1-1/16 Std. Thread	0.872	1.080	0.993	1.137	0.749	1.306	-	-
-	-	1.036	1.151	1.098	1.217	0.740	1.497	1 N.P.T.	ICP-32

NOTE: Tabular data for *Tapered Caps & Plugs* continued on next page.



**Tapered Caps & Plugs (continued)**

The tapered style can either be used as a cap or plug depending on application. Excellent for protecting threads and keeping unwanted contamination out of pipes, valves, tubing and most other cylindrical openings. The most economical solution for protecting standard size and unified threads.

- Typical wall thickness .032
- Color: Red, Blue - optional
- Material: Low Density Polyethylene
- LDPE service temperature 150° F (66° C)
- Applicable specs: MIL-C-5501/7, MIL-C52078, NAS-834
- Thermoplastic rubber service temperature: 275° F (132° C)
- RoHS compliant

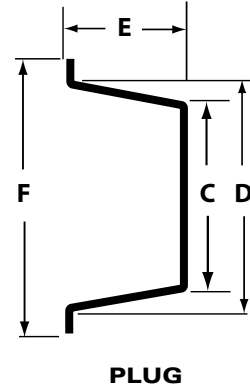
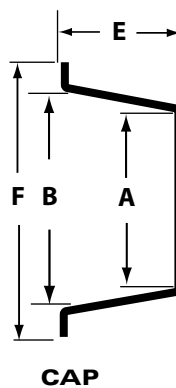

**TAPERED CAPS**

**TAPERED PLUGS**

CAP PART NUMBER	TYPICAL APPLICATION	A	B	C	D	E	F	TYPICAL APPLICATION	PLUG PART NUMBER
-	-	1.160	1.290	1.219	1.351	0.746	1.497	1-5/16 Std. Thread	ICP-34
ICP-35	1 N.P.T., 1-5/16 Std. Thread	1.176	1.298	1.236	1.359	0.749	1.497	-	-
-	-	1.386	1.531	1.452	1.593	0.741	1.748	1-1/4 N.P.T.	ICP-39
-	-	1.451	1.538	1.519	1.596	0.496	1.749	1-5/8 Std. Thread	ICP-40
ICP-41	1-1/4 N.P.T., 1-5/8 Std. Thread	1.491	1.616	1.559	1.683	0.739	1.874	1-3/4 Std. Thread	ICP-41
-	-	1.672	1.803	1.741	1.873	0.739	2.050	1-1/2 N.P.T., 1-7/8 Std. Thread	ICP-43
ICP-44	1-1/2 N.P.T., 1-7/8 Std. Thread	1.726	1.871	1.806	1.933	0.995	2.109	-	-
-	-	2.001	2.097	2.069	2.184	0.994	2.500	1-5/8 Std. Thread	ICP-49
-	-	2.145	2.174	2.215	2.260	0.491	2.473	2 N.P.T.	ICP-50
ICP-51	2-1/4 Std. Thread	2.086	2.275	2.162	2.343	1.000	2.640	-	-
ICP-53	2 N.P.T.	2.220	2.376	2.301	2.457	0.995	2.621	-	-
ICP-54	2-1/2 Std. Thread	2.235	2.540	2.400	2.600	1.000	2.812	-	-
-	-	2.550	2.750	2.648	2.796	0.746	3.008	2-1/2 N.P.T.	ICP-59
-	-	2.802	2.930	2.862	2.983	0.749	3.265	3 Std. Thread	ICP-60
ICP-61	2-1/2 N.P.T.	2.690	2.931	2.759	3.003	1.000	3.115	-	-
-	-	3.256	3.383	3.334	3.461	0.752	3.633	3 N.P.T.	ICP-65
ICP-66	3 N.P.T.	3.214	3.490	3.291	3.600	0.999	4.009	-	-
ICP-69	3-1/2 N.P.T.	3.717	3.855	3.806	3.938	0.745	4.150	3-1/2 N.P.T.	ICP-69
-	-	4.132	4.382	4.240	4.463	1.002	5.020	4 N.P.T.	ICP-72
ICP-73	4 N.P.T.	4.283	4.496	4.366	4.622	0.997	4.985	-	-