

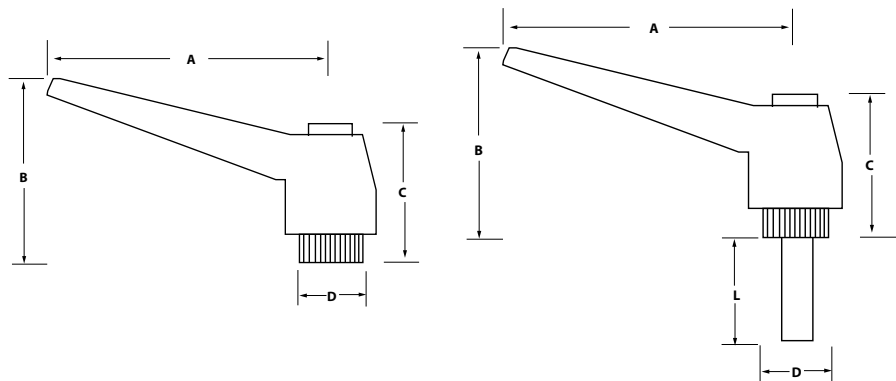

Adjustable Ratchet Handles

These *adjustable ratchet levers* are offered in both male and female thread types. The handle is made of glass reinforced nylon. Zinc plated steel stud or brass insert. Push the red button to lift and rotate the ratchet handle. Especially useful for confined space locations or when extra clamping force is required. Also available in *orange* color (add -O to part number).



ADJUSTABLE RATCHET HANDLES

P/N (female)	P/N (male)	Thread	A	B	C	D	L
IL220F-3	IL220M-3X75	10-24	1-3/4	1-1/4	1	1/2	3/4
IL221F-4	IL221M-4X75	1/4-20	1-3/4	1-1/4	1	1/2	3/4
IL221F-4		1/4-20	2-1/2	1-3/4	1-1/2	5/8	
IL222F-5	IL222M-5X118	5/16-18	2-1/2	1-3/4	1-1/2	5/8	1-3/16
	IL223M-5X156	5/16-18	2-1/2	1-3/4	1-1/2	5/8	1-9/16
IL224F-6	IL224M-6X118	3/8-16	3-1/4	2-1/4	1-3/4	3/4	1-3/16
	IL225M-6X156	3/8-16	3-1/4	2-1/4	1-3/4	3/4	1-9/16
IL226F-7	IL226M-7X138	1/2-13	4	2-5/8	2	1	1-3/8